

Operating Instructions

Air Top Evo 40 | 55



English

Contents

1	General information	3
1.1	Purpose of the document	3
1.2	Using this document.....	3
1.3	Warranty and liability.....	3
1.4	Use of symbols and highlighting	3
2	Safety	3
2.1	Intended use	3
2.2	General safety information	3
2.3	Regulations and legal requirements	4
3	Operation	4
3.1	Control elements	4
3.2	Switch the heater on and off	5
3.3	Using the heater in hazardous material vehicles (ADR)	5
3.4	Switching the heater on after automatic switch-off ...	5
4	Fuel.....	5
4.1	Converting from operation with summer diesel to winter diesel.....	5
5	Combustion air	5
6	Exhaust.....	5
7	Cleaning	5
8	Malfunctions	6
9	Service signal.....	7
10	Maintenance.....	7
11	Disposal	7
12	Service and customer services	7
13	Declaration of Conformity	7
14	Type approval AT40 55.....	8

1 General information

1.1 Purpose of the document

These operating instructions provide the user with information on the safe operation of the Air Top Evo 40 | 55.



NOTE

The actual availability of these functions depends on each installed heater.



NOTE

Carefully read through and follow the heater operating instructions and the safety information contained therein.

1.2 Using this document

- ✓ Before operating the Air Top Evo 40 | 55, carefully read these operating instructions as well as the operating instructions for the control element.
- ✓ Hand these operating instructions on to the following owner or user of the Air Top Evo 40 | 55.

To access further documents use one of the following options:

The Webasto Dealer Portal

(<https://dealers.webasto.com>)

Webasto Service app (for installation)

To download this app:

- ▶ scan the QR code below or



- ▶ go to:

<https://apps.apple.com/> (Apple App Store) or
<https://play.google.com/> (Google Play Store) as appropriate.

To use the Webasto Service App and access the online Webasto technical documentation, scan the QR code or the barcode on your Webasto product box.

Operating instructions are also available from the Webasto website at www.webasto.com. These instructions are available in a variety of other national languages on the Webasto website.

1.3 Warranty and liability

Webasto shall not assume liability for defects or damages that are the result of disregarding the installation and operating instructions. This liability exclusion particularly applies to:

- Installation or maintenance by untrained personnel.
- Improper use.
- Repairs not carried out by a Webasto service workshop.
- Use of non-genuine parts.
- Conversion of the unit without permission from Webasto.
- Mechanical damage to the equipment.
- Failure to comply with service instructions.



DANGER

Always switch off the heater before refuelling.

1.4 Use of symbols and highlighting



DANGER

This signal word denotes a hazard with a **high** degree of risk which, if not avoided, may lead to death or serious injury.



WARNING

This signal word denotes a hazard with a moderate degree of risk which, if not avoided, may lead to minor or moderate injury.



CAUTION

This signal word denotes a hazard with a **low** degree of risk which, if not avoided, may lead to minor or moderate injury.



NOTE

This symbol denotes a special technical feature, or (if not observed) potential damage to the product.



This symbol refers to separate documents which may be enclosed or can be requested from Webasto.

- ✓ Requirements for the following necessary action
- ▶ Necessary action

2 Safety

2.1 Intended use



NOTE

The heater must not be used for safety-related purposes. It serves to provide comfort.

The heater works independently of the vehicle engine and is integrated in the electrical system of the vehicle.

The heater is approved for the following applications:

- Car, light truck (LCV)
- Trucks, buses in EU vehicle classes **M**, **N** and **O**.
- Caravans, motor homes, boats, pleasure craft
- Earth-moving machinery
- Construction machines
- Vehicles that can be used in commercial, light-industrial and industrial environments.
- Agriculture and forestry machines

2.2 General safety information

2.2.1 Safety information on operation



DANGER

Risk of injury from the defective unit

Do not operate a defective Air Top Evo 40 | 55 and put it out of service by removing the fuse:

- prolonged heavy smoke development.
- unusual burner noise.
- smell of fuel.
- permanent fault switch-offs with error messages (flash code).
- damaged heater.
- ▶ Contact a Webasto service workshop.

DANGER
Risk of explosion from explosive and flammable hazardous goods
 For hazardous material vehicles, restriction of the heater operation (ADR) is required to prevent severe burns.

- ▶ Do not operate the heater at hazardous material loading points.
- ▶ Do not operate the heater when loading and unloading hazardous materials.

DANGER
Danger of fire
 Flammable materials or liquids in the hot air flow.

- ▶ Keep the hot air flow free.

DANGER
Danger of poisoning and suffocation due to exhaust fumes
 Make sure that:

- ▶ the casing rests only on the base after installation.
- ▶ the base seal is fitted correctly.
- ▶ Exhaust gasses are routed only to the outside.

WARNING
Danger of explosion and suffocation
 Do not operate the heater:

- ▶ at filling stations and tank facilities.
- ▶ at locations where highly flammable gases or dust can form, or at locations where highly flammable liquids or solid materials are stored (e.g. near fuel, coal and wood dust, grain storage areas, dry grass and leaves, cardboard boxes, paper, etc.).
- ▶ in closed rooms such as garages that do not have an exhaust extraction unit, especially not with programmed heating start (time preselect or remote start).

NOTE
Incorrect handling

- ▶ Protect the heater against mechanical stress (e.g. dropping, impacts or knocks).
- ▶ Do not stand on the heater.
- ▶ Do not place any objects on top of the heater.
- ▶ Avoid shutting down the heater incorrectly during the after-running period. After switching off via the control element, the fan of the heater continues to run.
- ▶ Always switch off the heater via the control element.
- ▶ Do not disconnect from the power supply until the after-running period has elapsed.

NOTE

- ▶ Do not operate heater without control unit cover in place.

2.2.2 Avoiding damage to property

NOTE

After switching off via the control element, the fan of the heater continues to run (shortened to 40 s for ADR). Switching off incorrectly, without after-run, can cause damage to the Air Top Evo 40 | 55.

- ▶ Always switch off the heater via the control element.
- ▶ The use of programmable control elements in ADR vehicles is not permitted.

NOTE

The heater is not approved for the purpose of directly heating the cargo area of ADR vehicles (hazardous substance transportation).

2.3 Regulations and legal requirements

The type approvals in accordance with the regulations ECE-R 122 (heating) and ECE-R 10 (EMC) for the Air Top Evo 40 | 55 heater apply in the area where the European regulation 2018/858 is valid.

i Read and comply with the warnings and information in the installation instructions and operating instructions.

3 Operation

DANGER
 Hazardous material vehicles (ADR) must not be switched on or off using a timer control or remote control.

3.1 Control elements

NOTE

Use suitable Webasto control elements approved for use with the heater.

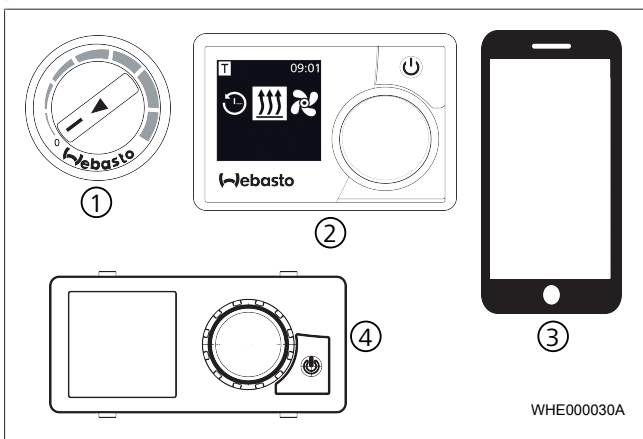

Fig. 1 Control elements

① Rotary switch	③ ThermoCall TC4 and ThermoConnect with mobile app
② MultiControl or SmartControl	④ UniControl

i Observe additional requirements from the operating and installation instructions for the Air Top Evo 40 | 55 and the control element.

The Air Top Evo 40 | 55 can be fitted with various control elements. A combination of control elements is possible.

3.2 Switch the heater on and off

The heater is switched on and off by different switch signals. Depending on the system equipment, the switch signals are produced by a switch, control element or a climate control system.



DANGER

Danger of explosion and suffocation

For ADR vehicles: The heater must only be switched on manually via a switch. The heater must not be switched on automatically via a programmable switch.



DANGER

Overheating possible

An emergency off switch may only be actuated in the event of danger since the heater will be switched off without after-running period.



NOTE

Always switch off the heater via the control element

After switching off via the control element, the heater switches to a short controlled run-on phase. Switching off incorrectly, without after-run, can cause damage to the heater.

3.3 Using the heater in hazardous material vehicles (ADR)

It is not possible to set a preselection time in hazardous material vehicles (ADR). The SmartControl (if present) shows how much heater operation time is left (remaining operation time).



NOTE

An ADR after-running period is applied in the following cases:

- the generator signal (D+, light machine) is discontinued.
- the pumping device (auxiliary drive) belonging to the vehicle is put into operation.

After the end of the ADR after-running period, the heater is in ADR locking mode.



NOTE

Release ADR lock:

- ▶ Put the pumping device belonging to the vehicle out of operation.
- ▶ Restart the heater by switching it off and on again using the control element.

3.4 Switching the heater on after automatic switch-off



NOTE

Possible loss of heating function

Following an automatic switch-off, the heater may need to be manually switched back on. The heater can be restarted by switching it off and on again using the control element.

4 Fuel

The heater is connected to the fuel tank of the vehicle or to a separate fuel tank.

▶ Suitable fuels:

- Air Top Evo 40 | 55 B: Petrol DIN EN 228

- Air Top Evo 40 | 55 D: Diesel DIN EN 590, biodiesel DIN EN 14214, HVO DIN EN 15940

4.1 Converting from operation with summer diesel to winter diesel

- ✓ The tank is filled up with winter diesel (cold-resistant fuel). However, the fuel system for the heater may still contain residues of summer diesel.
- ▶ Switch on the heater for approx. 15 minutes (the fuel system is completely filled with cold-resistant fuel).

5 Combustion air



DANGER

Danger of fire

Flammable materials or liquids in the combustion air flow.

- ▶ Keep combustion air flow clear.

6 Exhaust



WARNING

Blockages

Check combustion air and exhaust system for blockages.

A blocked exhaust system or combustion air system can cause unsafe status of the heater!

7 Cleaning



NOTE

Do not clean the Air Top Evo 40 | 55 with a high-pressure cleaner.

Carefully clean the heater using water and a cleaning agent suitable for cleaning vehicles.

With intake filter fitted on the cold air inlet: clean the intake filter.

8 Malfunctions



WARNING

Check combustion air and exhaust system for blockages.

A blocked exhaust system or combustion air system can cause unsafe status of the heater!

In the event of a malfunction, the control element can indicate a malfunction.

A malfunction is indicated by means of a flash code or on the control element display:

- On control elements with display, the fault codes F01 to F15 are output via the display. The fault codes F16 to F19 are shown with “- -”.
- On control elements without a display (analogue), the fault code is indicated in the form of a flash pulse. The pulses are short or long. The number of long pulses corresponds to the number of the fault code. F00 is just rapid flashing.
- In event of an error occurring, check the fuse and plug connectors.
- If the fault cannot be rectified by the measure described, contact your Webasto service workshop.



NOTE

Independent maintenance work, particularly using flammable gases or liquids such as accelerators, is forbidden.

Flash code	Hex	Dec	Fault description
F00 or 0*	00h	0	No error stored
F00 or 0*	A0h	160	Heater does not start
F01 or 1*	02h	2	Heater does not start
F01 or 1*	83h	131	Heating mode terminated
F02 or 2*	03h	3	Heating mode terminated
F03 or 3*	84h	132	Heater does not start, heating mode terminated
F10 or 10*	06h	6	Heater lock-out
-	17h	23	Heater does not start, heating mode terminated
-	32h	50	Heater does not start after control pause
-	-	-	On vehicles for transporting hazardous goods: Heater does not start, heating mode terminated
-	-	-	Heater exhaust emits black smoke

9 Service signal

In the event of service information, the service signal is shown via the control element when the heater is switched on.

- In the case of the MultiControl / SmartControl control element, a service symbol is displayed.
 - On control elements without display: indicator lamp flashes for 60 s: on for 1 s, off for 1 s.
- ▶ Have the heater checked by a professional.

The heater can continue to be used with limited operation.

10 Maintenance

- Put the heater into operation every 4 weeks in order to prevent mechanical parts from seizing.
- At the beginning of the heating period, have the heater checked by a professional.

11 Disposal

The Air Top Evo 40 | 55 must not be disposed of in household waste.

Observe the regional regulations for disposal of electronic products.

12 Service and customer services

The device is registered during installation by the Webasto service workshop. You will receive the registration document.

Pass the registration document on to the next owner or user of the device.



Do you have any technical questions or problem with the device?

National phone numbers of our representatives are provided on:

<https://www.webasto-group.com/en/the-company/locations-worldwide/>

13 Declaration of Conformity

UK-CA		UK-Konformitätserklärung UK-Declaration of Conformity		Webasto	
Hersteller Manufacturer		Webasto Roof & Components SE Krallinger Strasse 5 82131 Stockdorf Germany			
Für die Verwendung des Webasto Heizgerätesystems For the use of the Webasto heating system					
Air Top Evo 40					
Richtlinie Directive		Ausgewählte Normen Designated Standards			
Supply of Machinery (Safety) Regulations 2008		EN ISO 3744:2010 EN ISO 12100:2010 EN 61310-2:2008			
Electromagnetic Compatibility Regulations 2016		EN 61000-6-2:2005/AC:2005 EN 61000-6-3:2007/A1:2011 EN ISO 14982:2009 EN ISO 13766-1:2018			
RoHS Regulations 2012					
Ort und Datum der Ausstellung Place and Date of issue		Gieching, den 01.07.2024			
i.V. T. Zwicker VP Business Line ETF Webasto Roof & Components SE		i.A. J. Belz Certification & Compliance Expert Webasto Roof & Components SE			
Original in deutscher Fassung. Original in German version.					
Die alleinige Verantwortung für die Ausstellung dieser Konformitätserklärung trägt der Hersteller. This declaration of conformity is issued under the sole responsibility of the manufacturer.					

 UK-Konformitätserklärung UK-Declaration of Conformity		
Hersteller Manufacturer	Webasto Roof & Components SE Krallinger Strasse 5 82131 Stockdorf Germany	
Für die Verwendung des Webasto Heizgerätesystems For the use of the Webasto heating system		
Air Top Evo 55		
Richtlinie Directive	Ausgewählte Normen Designated Standards	
Supply of Machinery (Safety) Regulations 2008	EN ISO 3744:2010 EN ISO 12100:2010 EN 61310-2:2008	
Electromagnetic Compatibility Regulations 2016	EN 61000-6-2:2005/AC:2005 EN 61000-6-3:2007/A1:2011 EN ISO 14982:2009 EN ISO 13766-1:2018	
RoHS Regulations 2012		
Ort und Datum der Ausstellung Place and Date of issue	Gliching, den 01.07.2024	
i.V. T. Zwicker VP Business Line ETF Webasto Roof & Components SE	i.A. J. Belz Certification & Compliance Expert Webasto Roof & Components SE	
Original in deutscher Fassung. Original in German version.		
Die alleinige Verantwortung für die Ausstellung dieser Konformitätserklärung trägt der Hersteller. This declaration of conformity is issued under the sole responsibility of the manufacturer.		

14 Type approval AT40|55





 E1 122R - 00 0385	 Webasto Feel the Drive
 Kraftfahrt-Bundesamt DE-24932 Flensburg	
 MITTEILUNG	ausgestellt von: Kraftfahrt-Bundesamt
über die Erweiterung einer Genehmigung für einen Typ eines Bauteils nach der Regelung Nr. 122 einschließlich Änderung Nr. 00 Ergänzung 06	
COMMUNICATION	
issued by: Kraftfahrt-Bundesamt	
concerning the extension of an approval of a component type pursuant to Regulation No. 122 including amendment No. 00 supplement 06	
Genehmigungsnummer: E1*122R00/06*0385*07 Approval number:	
Grund (Gründe) für die Erweiterung (gegebenenfalls): Reason(s) of extension (if any): Technische Änderungen Technical modifications	
Redaktionelle Änderungen Editorial modifications	
Abschnitt I Section I	
Allgemeines General	
1.1. Marke (Firmenname des Herstellers): Make (trade name of manufacturer): Webasto Thermo & Comfort SE	
1.2. Typ: Type: Air Top Evo 40	
1.3. Merkmale zur Typidentifizierung, falls an der Einrichtung vorhanden: Means of identification of type, if marked on the device: Handelsbezeichnung General commercial description	

Fig. 2 Type approval Air Top 40 (page 1)

E1 122R - 00 0385 

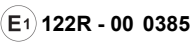
Kraftfahrt-Bundesamt
DE-24932 Flensburg

2

Genehmigungsnummer: E1*122R00/06*0385*07
Approval number:

1.3.1. Stelle, an der diese Merkmale angebracht sind:
Location of that marking:
Auf dem Gehäuse und nach dem Einbau zusätzlich am Fahrzeug
On the housing and after the installation additional on the vehicle

1.4. Name und Anschrift des Herstellers:
Name and address of manufacturer:
Webasto Thermo & Comfort SE
DE-82205 Giechling

1.5. Stelle, an der das ECE-Genehmigungszeichen angebracht ist:
Location of the ECE approval mark:
Auf dem Gehäuse
On the housing

1.6. Anschrift(en) der Fertigungsanlage(n):
Address(es) of assembly plant(s):
Webasto Thermo & Comfort SE (Werk Neubrandenburg)
DE-17033 Neubrandenburg

Abschnitt II
Section II

1. Zusätzliche Angaben (gegebenenfalls):
Additional information (if any):
Entfällt
Not applicable

2. Technischer Dienst, der die Prüfungen durchführt:
Technical service responsible for carrying out the tests:
DEKRA Automobil Test Center der DEKRA Automobil GmbH
DE-01998 Klettwitz

3. Datum des Gutachtens:
Date of test report:
04.05.2022

4. Nummer des Gutachtens:
Number of test report:
202254546 (7. Erweiterung)

Fig. 3 Type approval Air Top 40 (page 2)

E1 122R - 00 0386 

Kraftfahrt-Bundesamt
DE-24932 Flensburg

E1 MITTEILUNG
ausgestellt von:
Kraftfahrt-Bundesamt

über die Erweiterung einer Genehmigung für einen Typ eines Bauteils nach der Regelung Nr. 122 einschließlich Änderung Nr. 00 Ergänzung 06

COMMUNICATION
issued by:
Kraftfahrt-Bundesamt

concerning the extension of an approval of a component type pursuant to Regulation No. 122 including amendment No. 00 supplement 06

Genehmigungsnummer: E1*122R00/06*0386*06
Approval number:

Grund (Gründe) für die Erweiterung (gegebenenfalls):
Reason(s) of extension (if any):
Technische Änderungen
Technical modifications

Redaktionelle Änderungen
Editorial modifications

Abschnitt I
Section I

Allgemeines
General

1.1. Marke (Firmenname des Herstellers):
Make (trade name of manufacturer):
Webasto Thermo & Comfort SE

1.2. Typ:
Type:
Air Top Evo 55

1.3. Merkmale zur Typidentifizierung, falls an der Einrichtung vorhanden:
Means of identification of type, if marked on the device:
Typbezeichnung
Type designation

Fig. 5 Type approval Air Top 55 (page 1)

E1 122R - 00 0385 

Kraftfahrt-Bundesamt
DE-24932 Flensburg

3

Genehmigungsnummer: E1*122R00/06*0385*07
Approval number:

5. Bemerkungen (gegebenenfalls):
Remarks (if any):
Handelsbezeichnung(en):
General commercial description(s):
Air Top Evo 40 B (Benzin)
Air Top Evo 40 D (Diesel)
Air Top Evo 40 D High Altitude

6. Die Genehmigung wird erweitert
Approval is extended

7. Ort: DE-24932 Flensburg
Place:

8. Datum: 17.05.2022
Date:

9. Unterschrift: Im Auftrag
Signature:

Jörg Burghardt 



Fig. 4 Type approval Air Top 40 (page 3)

E1 122R - 00 0386 

Kraftfahrt-Bundesamt
DE-24932 Flensburg

2

Genehmigungsnummer: E1*122R00/06*0386*06
Approval number:

1.3.1. Stelle, an der diese Merkmale angebracht sind:
Location of that marking:
Auf dem Gehäuse und nach dem Einbau zusätzlich am Fahrzeug
On the housing and after the installation additional on the vehicle

1.4. Name und Anschrift des Herstellers:
Name and address of manufacturer:
Webasto Thermo & Comfort SE
DE-82205 Giechling

1.5. Stelle, an der das ECE-Genehmigungszeichen angebracht ist:
Location of the ECE approval mark:
Auf dem Gehäuse
On the housing

1.6. Anschrift(en) der Fertigungsanlage(n):
Address(es) of assembly plant(s):
Webasto Thermo & Comfort SE (Werk Neubrandenburg)
DE-17033 Neubrandenburg

Abschnitt II
Section II

1. Zusätzliche Angaben (gegebenenfalls):
Additional information (if any):
Entfällt
Not applicable

2. Technischer Dienst, der die Prüfungen durchführt:
Technical service responsible for carrying out the tests:
DEKRA Automobil Test Center der DEKRA Automobil GmbH
DE-01998 Klettwitz

3. Datum des Gutachtens:
Date of test report:
21.03.2022

4. Nummer des Gutachtens:
Number of test report:
202254154 (6. Erweiterung)

Fig. 6 Type approval Air Top 55 (page 2)

E1 122R - 00 0386 

 **Kraftfahrt-Bundesamt**
DE-24932 Flensburg

3

Genehmigungsnummer: E1*122R00/06*0386*06
Approval number:

5. Bemerkungen (gegebenenfalls):
Remarks (if any):
Handelsbezeichnung(en):
General commercial description(s):
Air Top Evo 55 B (Benzin)
Air Top Evo 55 D (Diesel)

6. Die Genehmigung wird erweitert
Approval is extended

7. Ort: DE-24932 Flensburg
Place:

8. Datum: 12.04.2022
Date:

9. Unterschrift: Im Auftrag
Signature:

Jörg Burghardt



Fig. 7 Type approval Air Top 55 (page 3)

To request this documentation in another language, please locate and contact your local Webasto dealer. You can find your nearest dealer at: <https://dealerlocator.webasto.com/en-int>.
To provide feedback (in English or German), please email: feedback2tdt@webasto.com

WEBBUTTLERTECHNIK

Europe, Asia Pacific:

Webasto
Kraillinger Str. 5
82131 Stockdorf
Germany

UK only:

Webasto Thermo & Comfort UK Ltd
Webasto House
White Rose Way
Doncaster Carr
South Yorkshire
DN4 5JH
United Kingdom

Only within Germany
Tel: 0395 5592 444
Mail: technikcenter@webasto.com



9030680C

www.webasto.com