

29.2180.01.0425

## RENAULT TRAFIC & VAUXHALL VIVARO FUEL TEE-PIECE CONNECTION INCLUDING FUEL PRESSURE REDUCTION VALVE (FPR VALVE)



PART NUMBER	DESCRIPTION	QTY
29.2100.17.1104	Raymond Tee-Piece Connector	1
22.1000.20.3000	Adaptor Fuel 7.5mm to 3.5mm	1
10.2063.01.1098	Clip – 11mm Fuel 46011	2
29.2100.17.1129	Fuel Line 2mm ID, 4mm OD Blue 2 Metre	1
22.1000.20.0800	Pressure Regulator 0.2 - 4 bar for FMP	1
360.75.300	Hose Fuel – 3.5 x 3mm	0.05 m
29.2100.17.1004	Clip – 9mm Pt 46009 A	2
29.2100.01.1034	Clip P – 20mm With Rubber B	1
29.2100.01.9167	Angle Bracket – Exhaust C	1
108.10.325	Screw No10 x 1/2" Pan Pozi AB	1
29.2100.01.9331	Screw M6 x 25mm Hex Head Z+P	1
81.1206.03.0168	Nut M6 x 1.0 Z+P	1
81.1206.02.0039	Washer M6 Spring Z+P	1
29.2100.20.1065	Inst. Fuel Kit Traffic / Vivaro P/N 0425 A	1

### FUEL METERING PUMP AND PRESSURE REGULATOR ASSEMBLY

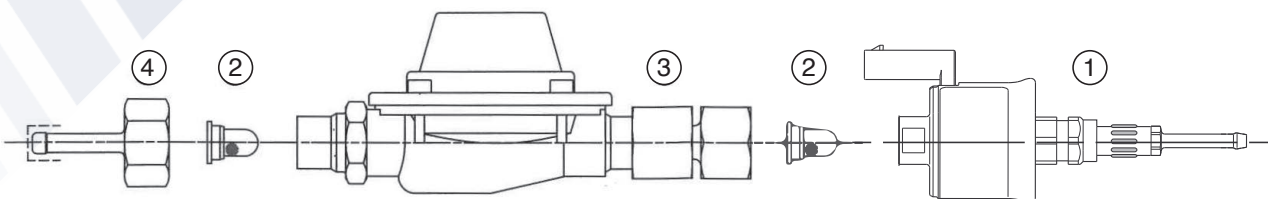

- 1 Fuel Metering Pump
- 2 Pot-Type Strainer
- 3 Pressure Regulator
- 4 Connection

## 29.2180.01.0425

# RENAULT TRAFIC & VAUXHALL VIVARO FUEL TEE-PIECE CONNECTION INCLUDING FUEL PRESSURE REDUCTION VALVE (FPR VALVE)

Using a 12mm and 17mm spanner, remove the intake spigot from the fuel metering pump (FMP) and discard the pot-type strainer.

Insert the two new pot strainers into the FMP and FPR valve. Fit the FPR valve to the intake of the FMP in place of the original connector (tightening torque 21 +5 / -0 Nm).

Fit the original connection to the FPR (tightening torque 10 +1 / -0 Nm).

Using the brackets supplied, fasten the assembly in the suggested position underneath the vehicle on the chassis cross member near the fuel filter. The holes for the fixings should line up horizontally, this will also ensure that the fuel pump assembly is fitted at the correct angle.

### ATTENTION!

**Do not fit plastic tee-piece into vehicle line until the fuel line is connected to the fuel metering pump assembly.**

Fasten the blue fuel line to the plastic tee-piece using the 7.5-3.5mm reducer and 2 x 11mm fuel clips, route the fuel line to the FMP assembly and attach the blue fuel line using the straight rubber connector and 9mm fuel clips.

Insert the quick fit plastic tee-piece into vehicle's return fuel line at the quick fit connection, as shown in Figure on right.

### NOTE

**Due to the additional FPR valve, bleeding the heater fuel system will take longer than usual.**

