

29.2180.01.0232

RENAULT TRAFIC & VAUXHALL VIVARO FUEL TEE-PIECE CONNECTION  
INCLUDING FUEL PRESSURE REDUCTION VALVE (FPR VALVE)



PART NUMBER	DESCRIPTION	QTY
29.2100.17.1104	Plastic Tee-Piece	1
22.1000.20.0800	FPR Valve – Includes 2 Pot Filters	1
10.2063.01.1098	11mm Clip	2
29.2100.17.1004	9mm Clip	2
29.2100.01.1034	20mm P-Clip	1
22.1000.20.3000	7.5-3.5mm Reducer	1
25.1888.80.0102	6-4mm Reducer	1
29.2100.01.9167	Angle Bracket	1
890.31.054	2mm Fuel Line	2m
108.10.325	No10 x 1/2" Screw	1
29.2100.01.9331	M6 x 25mm Hex Bolt	1
110.10.026	M6 Hex Nut	1
171.22.086	M6 Spring Washer	1

FUEL METERING PUMP AND PRESSURE REGULATOR ASSEMBLY

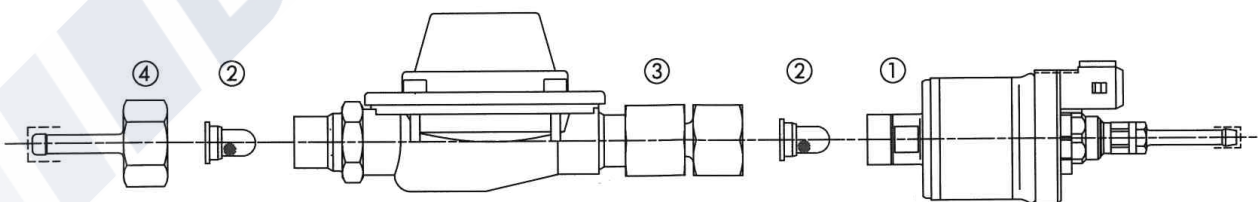

- 1 Fuel Metering Pump
- 2 Pot-Type Strainer
- 3 Pressure Regulator
- 4 Connection

## 29.2180.01.0232

# RENAULT TRAFIC & VAUXHALL VIVARO FUEL TEE-PIECE CONNECTION INCLUDING FUEL PRESSURE REDUCTION VALVE (FPR VALVE)

Using a 12mm and 17mm spanner, remove the intake spigot from the fuel metering pump (FMP) and discard the pot-type strainer.

Insert the two new pot strainers into the FMP and FPR valve. Fit the FPR valve to the intake of the FMP in place of the original connector (tightening torque 21 +5 / -0 Nm).

Fit the original connection to the FPR (tightening torque 10 +1 / -0 Nm).

Using the brackets supplied, fasten the assembly in the suggested position underneath the vehicle on the chassis cross member near the fuel filter. The holes for the fixings should line up horizontally, this will also ensure that the fuel pump assembly is fitted at the correct angle.



### IMPORTANT!

**Do not fit plastic tee-piece into vehicle line until the fuel line is connected to the fuel metering pump assembly.**

Fasten the blue fuel line to the plastic tee-piece using the 7.5-3.5mm reducer and 2 x 11mm fuel clips, route the fuel line to the FMP assembly and attach the blue fuel line using the 6-4mm reducer and 9mm fuel clips.

Insert the quick fit plastic tee-piece into vehicle's return fuel line at the quick fit connection, as shown in Figure on right.

### Please Note!

**Due to the additional FPR valve, bleeding the heater fuel system will take longer than usual.**

