

AIRTRONIC MINI-CONTROLLER

EN

INSTALLATION INSTRUCTIONS

WARRANTY AND LIABILITY

Eberspächer does not accept any liability for defects and damage, which are due to installation or repair by unauthorised and untrained persons. Compliance with the official regulations and the safety instructions is prerequisite for liability claims.

Failure to comply with the official regulations and safety instructions leads to exclusion of any liability of the heater manufacturer.

ACCIDENT PREVENTION

Always follow all accident prevention regulations and shop and operating safety instructions.

AIRTRONIC MINI-CONTROLLER

Order No. 22.1000.32.0700

SCOPE OF SUPPLY

- | | |
|---------------------|-------------------------|
| 1 Mini controller | 1 Connector housing, S2 |
| 1 Drilling template | 1 Bush housing |
| 1 Elastic underlay | 5 Contacts |
| 1 Screw | |

CIRCUIT DIAGRAM

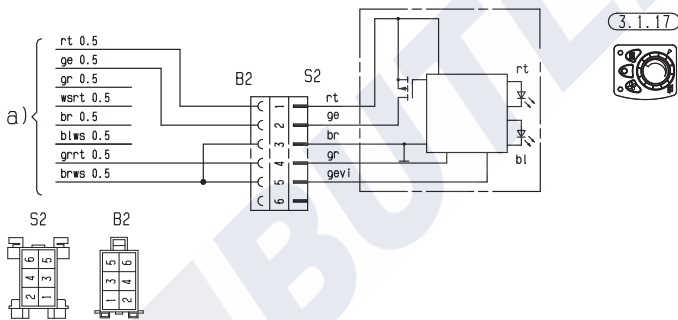

NOTE

If the mini controller and the mini timer are used with a further control unit, then please contact the manufacturer about the electrical wiring.

INSTALLATION DRAWING

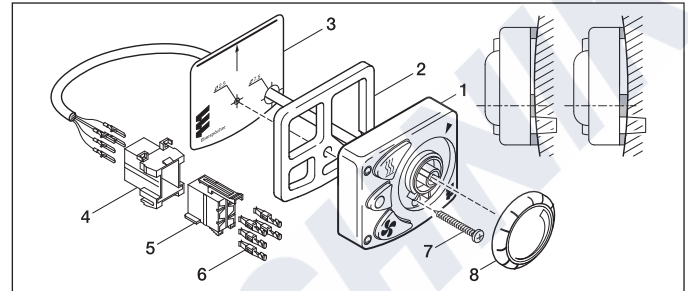

- | | |
|-------------------------|--------------------|
| 1 Mini controller | 5 Bush housing, B2 |
| 2 Elastic underlay | 6 Contacts |
| 3 Drilling template | 7 Screw |
| 4 Connector housing, S2 | 8 Rotary knob |

INSTALLATION

NOTE

The drilling template (pull-off and self-adhesive) is attached to the Airtronic Mini-Controller Quick Start Guide.

- Stick the drilling template in the required installation place.
- Drill Ø 2.5 and 7.5 mm holes.
- Pull the rotary knob off the mini controller.
- Install the mini controller with the elastic underlay.
- Screw in the fastening screw up to the limit stop.
- Push the rotary knob onto the mini controller – the locking device in the rotary knob must be inserted in the groove in the mini controller.
- The mini controller is connected as shown in the circuit diagram.

PARTS LIST

3.1.17 Airtronic Mini-Controller

- a) Connection of control units at the heater
- | | |
|------|--|
| rt | Power supply, positive, terminal 30 |
| ge | Switch-on signal S+ |
| gr | Actual temperature value |
| wsrt | Switch off the anti-theft alarm system |
| br | Power supply, negative, terminal 31 |
| blws | Diagnostics |
| grrt | Temperature setpoint value |
| brws | Reference signal sensor |

Insulate unused cable ends.

Connectors and bush housings are shown from the cable inlet side.

CABLE COLOURS

rt	red	gr	grey	sw	black
bl	blue	ge	yellow	gn	green
ws	white	vi	violet	br	brown
li	purple				